

# SERIES CT-207

Conical Tip Tab Tool, Groove in Wire Direction and Cross Groove

## STANDARD ROUND

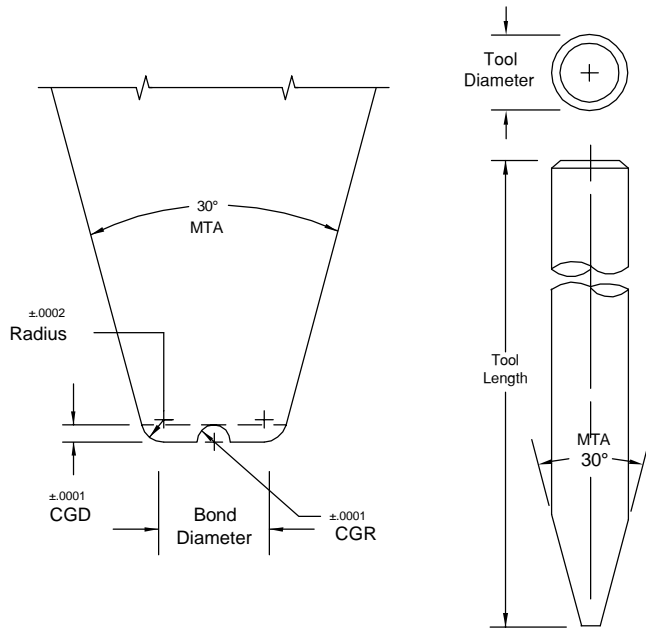

For Standard Round specify TD only  
For Optional Flat specify TD and TDF

MTA = MAIN TAPER ANGLE

Special dimensions available upon request.  
Dimensions not shown please specify.  
We recommend ceramic material for all gold wire bonding for optimum results.

## OPTIONAL FLAT

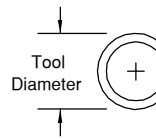

	TD		TDF	
	in.	mm	in.	mm
1/16	.0624	1.59	.0460	1.17
	.0784	1.99	.0630	1.60
3/32	.0937	2.38	.0880	2.24
	.1180	3.00	.0985	2.50
1/8	.1249	3.17	.0937	2.38
1/8	.1249	3.17	.1180	3.00

**SAMPLE PART NUMBER: M-CT-207-1/16-1-.001-M-C-.0010-\***

**SYMBOL EXPLANATION:** 1 2 3 4 5 6 7 8 9 10

**1. MATERIAL:**

M = Ceramic  
C = Tungsten Carbide  
T = Titanium

All other: Material Selection Guide **Tool Tips**

**2. SERIES:** CT

**3. STYLE:** 207

**4. TOOL DIAMETER:** Please specify

**5. TOOL LENGTH:** Please specify

**10. Tool Option:**

Please specify MTA (Tool-Angle)  
or see **Tool Options**

**9. WIRE:**

Please specify Wire Ø  
GR/CGR=60% of wire Ø.  
GD/CGD=35% of wire Ø.

**8. RADIUS:** See Option Chart below.

**7. FOOT FINISH:**

M = Matte  
P = Polished Radius

**6. BOND DIAMETER:** Please specify  
(Includes 2/3 R)

RADIUS OPTION CHART	OPTION LETTER		A	C	F	J
	RADIUS					
	in.		.0005	.0010	.0015	.0020
	µ		13	25	38	51